

220-240V 50 1~**GENERAL DATA**

Application: LBP
Refrigerant: R600a
Evaporating Temperature Range: -35°C to -10°C
Compressor Cooling: Static
Type: Hermetic reciprocating
Technology Type: On-Off
Expansion Device: Capillary Tube
Packing Quantity: Multi - 88 pcs
Displacement: 7.96 cm³
Horse power: 1.7 hp

Approvals:   

MECHANICAL DATA

Bore: 24 mm
Stroke: 17.6 mm
Oil Charge: 150ml +/-15ml
Free Internal Volume: 1.5 cm³
Maximum Recommended Refrigerant Charge: 150 g
Oil Type Configuration: Alkylbenzene
Oil Type Viscosity: ISO5
Compressor pressurization: Light vacuum
Weight: 8 kg

ELECTRICAL DATA

Motor Type: RSCR
Starting Torque: LST
Voltage working range at 50 Hz: 198-254 V
Maximum Motor Temperature: 130 °C
Start Winding Resistance: 21.78 Ω (± 10%) at 25°C
Run Winding Resistance: 22.58 Ω (± 10%) at 25°C

MOUNTING ACCESSORIES

	Description	Code
Terminal Board:	no	-
Overload Protector Bracket:	no	-
Washer:	no	-
Pin:	no	-
Clip:	no	-
Rotolock valve:	no	-
Cover:	yes	2075282
Anchorage:	yes	1027058
Grommets:	yes	2221011
Sleeves:	yes	2222018
Capacitor Bracket:	yes	2256008

ELECTRICAL COMPONENTS

	Component type	Description	Code
Starting Device:	TSD	TSD2 220V	513605532
Run Capacitor:		3 MFD	2253108
Motor Protection:	External	4TM197JDBYY-73	2312014

EXTERNAL CHARACTERISTICS

Base Plate: European
Tray Holder: Yes
Height: 166 mm

	Internal Diameter (mm)	Material	Shape
Suction Connector	6.1	Copper	Slanted 42°
Discharge Connector	4.9	Copper	Straight
Process Connector	5.92	Copper	Slanted 43°

RATED POINT DATA

Cooling Capacity (W)	Power Consumption (W)	Current Consumption (A)	Gas Flow Rate (kg/h)	Efficiency (W/W)
±5%	±5%	±5%	±5%	±7%
132	70	0.35	1.42	1.90

Test condition: ASHRAE, Static, Return Gas 32.2°C, Evaporating: -23.3°C, Condensing: 54°C, Ambient: 32.2°C, Liquid: 32.2°C

PERFORMANCE CURVE DATA

220V 50Hz

Condensing Temperature (°C)	Evaporating Temperature (°C)	Cooling Capacity (W)	Power Consumption (W)	Current Consumption (A)	Gas Flow Rate (kg/h)	Efficiency (W/W)
		±5%	±5%	±5%	±5%	±7%
35°C	-10	284	86	0.41	3.06	3.30
	-15	229	79	0.37	2.46	2.91
	-20	181	71	0.34	1.94	2.56
	-25	140	62	0.31	1.50	2.25
	-30	106	54	0.27	1.13	1.97
	-35	79	46	0.24	0.84	1.72

Condensing Temperature (°C)	Evaporating Temperature (°C)	Cooling Capacity (W)	Power Consumption (W)	Current Consumption (A)	Gas Flow Rate (kg/h)	Efficiency (W/W)
		±5%	±5%	±5%	±5%	±7%
45°C	-10	273	95	0.46	2.94	2.88
	-15	218	85	0.41	2.34	2.58
	-20	171	74	0.37	1.83	2.29
	-25	130	64	0.32	1.40	2.03
	-30	98	55	0.28	1.04	1.78
	-35	72	46	0.24	0.77	1.55

Condensing Temperature (°C)	Evaporating Temperature (°C)	Cooling Capacity (W)	Power Consumption (W)	Current Consumption (A)	Gas Flow Rate (kg/h)	Efficiency (W/W)
		±5%	±5%	±5%	±5%	±7%
55°C	-10	258	102	0.49	2.78	2.52
	-15	204	90	0.44	2.19	2.27
	-20	158	77	0.38	1.69	2.04
	-25	119	66	0.34	1.27	1.80
	-30	87	55	0.29	0.93	1.57
	-35	63	47	0.25	0.68	1.36

Test condition: ASHRAE, Static, Return Gas 32.2°C, Ambient: 32.2°C, Liquid: 32.2°C

ASSEMBLY INSTRUCTION

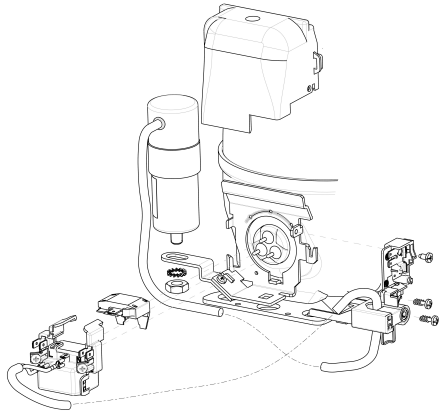

WIRING DIAGRAM

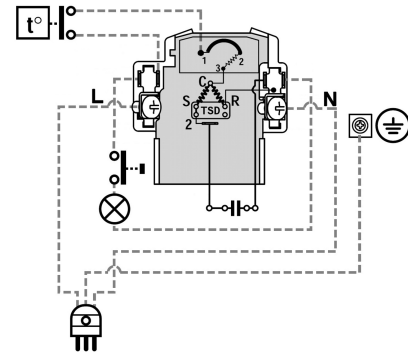

OPERATING ENVELOPE

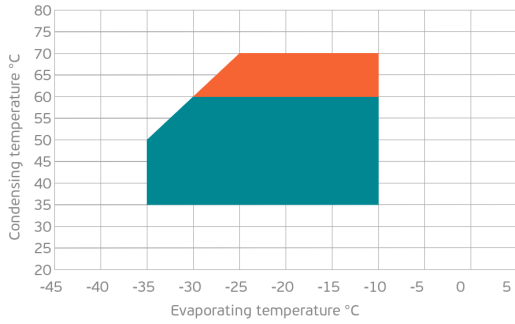

- Operating Condition
- Transient Condition
- Superheating

NOTE: usage of compressors outside of intended working range cannot make use of the warranty, or should be consulted with Technical support.

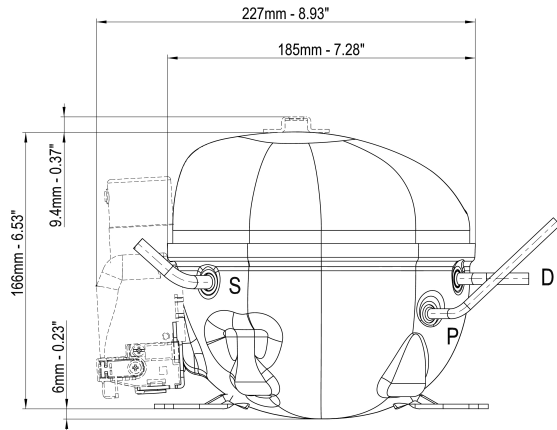

	∅ mm	∅ in	Material
S - Suction	6.10 - 6.20	0.24	Cu
P - Process	5.92 - 6.08	0.23	Cu
D - Discharge	4.90 - 5.02	0.19	Cu

