

115-127V 60 1~**GENERAL DATA**

Application: LBP
Refrigerant: R404A
Evaporating Temperature Range: -40°C to -10°C
Compressor Cooling: Fan
Fan air flow: 520 m³/h
Type: Hermetic reciprocating
Technology Type: On-Off
Expansion Device: Capillary Tube or Expansion Valve
Packing Quantity: Single - 1 pc
Displacement: 20.4 cm³
Horse power: 1 hp

Approvals:  

MECHANICAL DATA

Bore: 36.99 mm
Stroke: 19.03 mm
Oil Charge: 450ml +/-15ml
Free Internal Volume: 3.3 cm³
Maximum Recommended Refrigerant Charge: 800 g
Oil Type Configuration: Polyolester
Oil Type Viscosity: ISO22
Compressor pressurization: Dry air charge
Weight: 17.5 kg

ELECTRICAL DATA

Motor Type: CSR
Starting Torque: HST
Voltage working range at 60 Hz: 103-134 V
Maximum Motor Temperature: 130 °C
Start Winding Resistance: 2.33 Ω (± 10%) at 25°C
Run Winding Resistance: 0.49 Ω (± 10%) at 25°C
Locked Rotor Amperage (LRA): 57 A

MOUNTING ACCESSORIES

	Description	Code
Terminal Board:	no	-
Anchorage:	no	-
Overload Protector Bracket:	no	-
Capacitor Bracket:	no	-
Grommets:	yes	2221004
Sleeves:	yes	2222016
Washer:	no	-
Pin:	no	-
Clip:	no	-
Rotolock valve:	no	-
Cover:	yes	2075210

ELECTRICAL COMPONENTS

	Component type	Description	Code
Start Capacitor:		243-292 MFD 250V	2252331
Run Capacitor:		35 MFD	2253315
Starting Device:	Potential relay	RVA9AD3C-121	1253050
CSR / CSIR Box:	yes		1272325
Motor Protection:	External 3/4"	MST00AEK-3090	2291065

EXTERNAL CHARACTERISTICS

Base Plate: Universal
Tray Holder: No
Height: 220 mm

	Internal Diameter (mm)	Material	Shape
Suction Connector	9.6	Copper	Vertical
Discharge Connector	6.42	Copper	Vertical
Process Connector	6.42	Copper	Vertical

RATED POINT DATA

Cooling Capacity (W)	Power Consumption (W)	Current Consumption (A)	Gas Flow Rate (kg/h)	Efficiency (W/W)
±5%	±5%	±5%	±5%	±7%
1 172	846	7.83	27.10	1.38

Test condition: ASHRAE, Fan, Return Gas 32.2°C, Evaporating: -23.3°C, Condensing: 54°C, Ambient: 32.2°C, Liquid: 32.2°C

PERFORMANCE CURVE DATA

115V 60Hz

Condensing Temperature (°C)	Evaporating Temperature (°C)	Cooling Capacity (W)	Power Consumption (W)	Current Consumption (A)	Gas Flow Rate (kg/h)	Efficiency (W/W)
		±5%	±5%	±5%	±5%	±7%
35°C	-10	2 466	1 015	9.26	58.20	2.43
	-15	2 020	928	8.52	47.37	2.18
	-20	1 624	839	7.76	37.84	1.94
	-25	1 275	747	6.99	29.56	1.71
	-30	976	655	6.20	22.52	1.49
	-35	725	560	5.39	16.68	1.29
	-40	523	464	4.57	12.00	1.13

Condensing Temperature (°C)	Evaporating Temperature (°C)	Cooling Capacity (W)	Power Consumption (W)	Current Consumption (A)	Gas Flow Rate (kg/h)	Efficiency (W/W)
		±5%	±5%	±5%	±5%	±7%
45°C	-10	2 351	1 127	10.38	55.37	2.09
	-15	1 914	1 012	9.32	44.79	1.89
	-20	1 525	899	8.30	35.46	1.70
	-25	1 183	787	7.31	27.37	1.50
	-30	888	677	6.36	20.46	1.31
	-35	641	569	5.45	14.72	1.13

Condensing Temperature (°C)	Evaporating Temperature (°C)	Cooling Capacity (W)	Power Consumption (W)	Current Consumption (A)	Gas Flow Rate (kg/h)	Efficiency (W/W)
		±5%	±5%	±5%	±5%	±7%
55°C	-10	2 146	1 205	11.29	50.47	1.78
	-15	1 736	1 067	9.92	40.54	1.63
	-20	1 371	933	8.64	31.83	1.47
	-25	1 053	804	7.45	24.31	1.31
	-30	780	680	6.35	17.94	1.15

Test condition: ASHRAE, Fan, Return Gas 32.2°C, Ambient: 32.2°C, Liquid: 32.2°C

ASSEMBLY INSTRUCTION

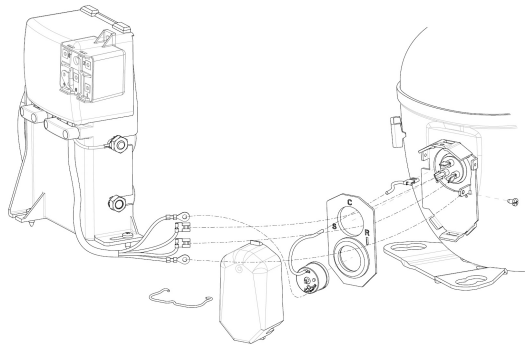

WIRING DIAGRAM

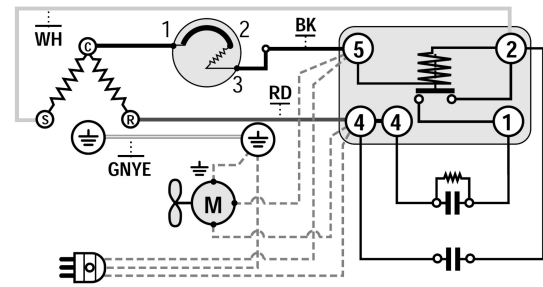

OPERATING ENVELOPE

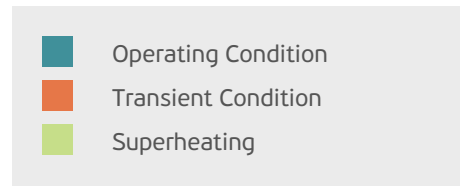
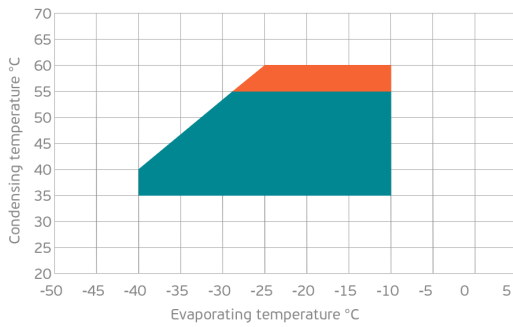

NOTE: usage of compressors outside of intended working range cannot make use of the warranty, or should be consulted with Technical support.

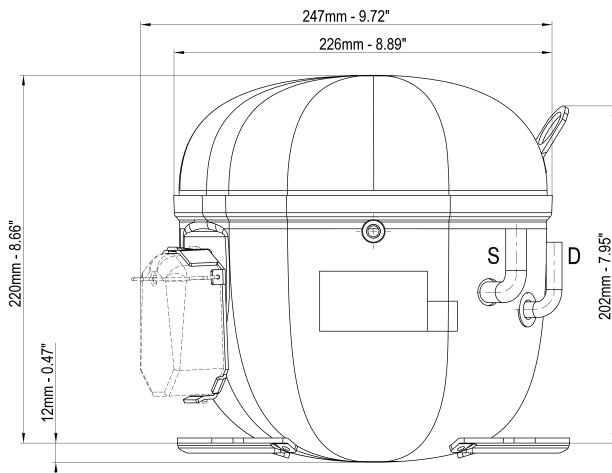

	∅ mm	∅ in	Material
S - Suction	9.60	0.37	Cu
P - Process	6.42	0.25	Cu
D - Discharge	6.42	0.25	Cu

