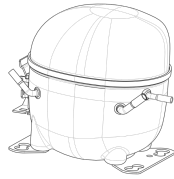

**115V 60 1~****GENERAL DATA**

**Application:** LBP  
**Refrigerant:** R404A  
**Evaporating Temperature Range:** -40°C to -10°C  
**Compressor Cooling:** Fan  
**Fan air flow:** 520 m<sup>3</sup>/h  
**Type:** Hermetic reciprocating  
**Technology Type:** On-Off  
**Expansion Device:** Capillary Tube or Expansion Valve  
**Packing Quantity:** Single - 1 pc  
**Displacement:** 8.77 cm<sup>3</sup>  
**Horse power:** 1.2 hp

Approvals:   

**MECHANICAL DATA**

**Bore:** 26.5 mm  
**Stroke:** 15.92 mm  
**Oil Charge:** 350ml +/-15ml  
**Free Internal Volume:** 2.1 cm<sup>3</sup>  
**Maximum Recommended Refrigerant Charge:** 350 g  
**Oil Type Configuration:** Polyolester  
**Oil Type Viscosity:** ISO22  
**Compressor pressurization:** Dry air charge  
**Weight:** 10.9 kg

**ELECTRICAL DATA**

**Motor Type:** CSIR  
**Starting Torque:** HST  
**Voltage working range at 60 Hz:** 103-127 V  
**Maximum Motor Temperature:** 130 °C  
**Start Winding Resistance:** 6.83 Ω (± 10%) at 25°C  
**Run Winding Resistance:** 1.66 Ω (± 10%) at 25°C  
**Locked Rotor Amperage (LRA):** 38 A

**MOUNTING ACCESSORIES**

	Description	Code
<b>Terminal Board:</b>	no	-
<b>Anchorage:</b>	no	-
<b>Washer:</b>	no	-
<b>Pin:</b>	no	-
<b>Clip:</b>	no	-
<b>Rotolock valve:</b>	no	-
<b>Overload Protector Bracket:</b>	yes	2075299
<b>Capacitor Bracket:</b>	yes	2255007
<b>Cover:</b>	yes	2075278
<b>Grommets:</b>	yes	2221003
<b>Sleeves:</b>	yes	2222015

**ELECTRICAL COMPONENTS**

	Component type	Description	Code
<b>Start Capacitor:</b>		189-227 MFD 165V	2252335
<b>Motor Protection:</b>	External 3/4"	T0793/G9	2321086
<b>Starting Device:</b>	Current relay	MTRPH-64-08	2283073

**EXTERNAL CHARACTERISTICS**

**Base Plate:** Universal  
**Tray Holder:** No  
**Height:** 200 mm

	Internal Diameter (mm)	Material	Shape
<b>Suction Connector</b>	8.1	Copper	Slanted 42°
<b>Discharge Connector</b>	6.45	Copper	Straight
<b>Process Connector</b>	6.45	Copper	Slanted 42°

**RATED POINT DATA**

Cooling Capacity (W)	Power Consumption (W)	Current Consumption (A)	Gas Flow Rate (kg/h)	Efficiency (W/W)
±5%	±5%	±5%	±5%	±7%
574	432	5.50	13.28	1.33

Test condition: ASHRAE, Fan, Return Gas 32.2°C, Evaporating: -23.3°C, Condensing: 54°C, Ambient: 32.2°C, Liquid: 32.2°C

**PERFORMANCE CURVE DATA****115V 60Hz**

Condensing Temperature (°C)	Evaporating Temperature (°C)	Cooling Capacity (W)	Power Consumption (W)	Current Consumption (A)	Gas Flow Rate (kg/h)	Efficiency (W/W)
		±5%	±5%	±5%	±5%	±7%
<b>35°C</b>	-10	1 064	509	6.02	25.13	2.09
	-15	882	462	5.72	20.69	1.91
	-20	721	418	5.46	16.79	1.72
	-25	579	377	5.24	13.43	1.54
	-30	458	338	5.06	10.57	1.36
	-35	357	302	4.91	8.21	1.18
	-40	276	269	4.81	6.34	1.03

Condensing Temperature (°C)	Evaporating Temperature (°C)	Cooling Capacity (W)	Power Consumption (W)	Current Consumption (A)	Gas Flow Rate (kg/h)	Efficiency (W/W)
		±5%	±5%	±5%	±5%	±7%
<b>45°C</b>	-10	1 035	539	6.23	24.39	1.92
	-15	855	490	5.89	20.01	1.74
	-20	694	443	5.60	16.14	1.57
	-25	552	397	5.33	12.78	1.39
	-30	430	353	5.11	9.91	1.22
	-35	327	310	4.92	7.51	1.06

Condensing Temperature (°C)	Evaporating Temperature (°C)	Cooling Capacity (W)	Power Consumption (W)	Current Consumption (A)	Gas Flow Rate (kg/h)	Efficiency (W/W)
		±5%	±5%	±5%	±5%	±7%
<b>55°C</b>	-10	1 007	581	6.51	23.67	1.73
	-15	828	526	6.10	19.33	1.57
	-20	667	471	5.73	15.49	1.42
	-25	525	416	5.40	12.13	1.26
	-30	402	362	5.10	9.25	1.11

Test condition: ASHRAE, Fan, Return Gas 32.2°C, Ambient: 32.2°C, Liquid: 32.2°C

**ASSEMBLY INSTRUCTION**

**WIRING DIAGRAM**

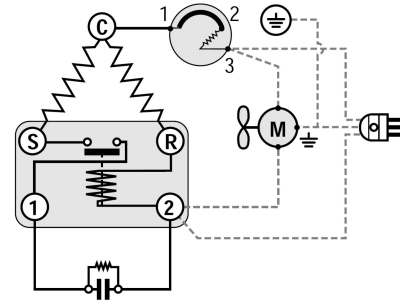
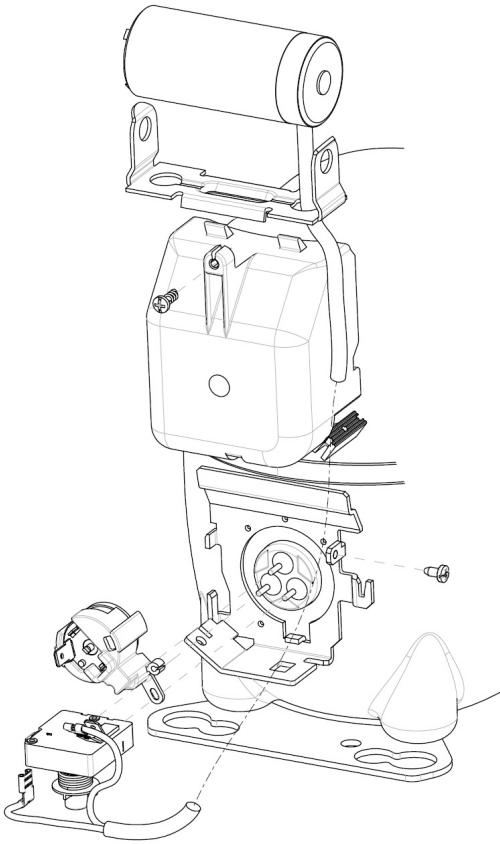

**OPERATING ENVELOPE**

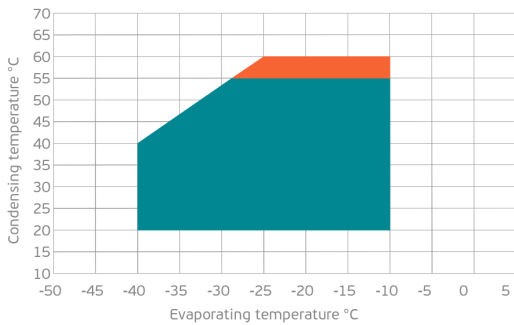

- Operating Condition
- Transient Condition
- Superheating

**NOTE:** usage of compressors outside of intended working range cannot make use of the warranty, or should be consulted with Technical support.

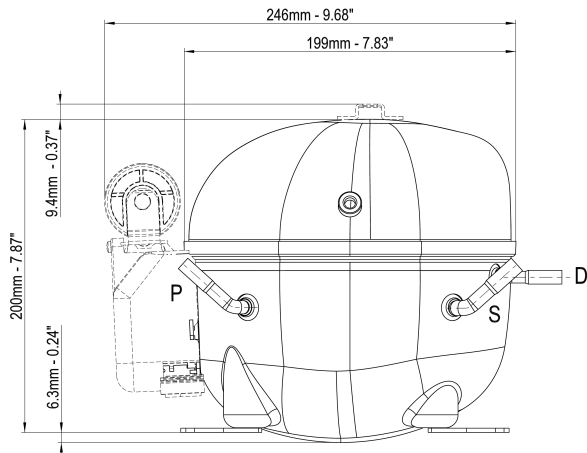

	∅ mm	∅ in	Material
<b>S - Suction</b>	8.10 - 8.20	0.32	Cu
<b>P - Process</b>	6.45 - 6.55	0.25	Cu
<b>D - Discharge</b>	6.45 - 6.55	0.25	Cu

