

220-240V 50 1~**GENERAL DATA**

Application: LBP
Refrigerant: R600a
Evaporating Temperature Range: -35°C to -10°C
Compressor Cooling: Static
Type: Hermetic reciprocating
Technology Type: On-Off
Expansion Device: Capillary Tube
Packing Quantity: Multi - 100 pcs
Displacement: 12.21 cm³
Horse power: 1.5 hp

Approvals:   

MECHANICAL DATA

Bore: 26 mm
Stroke: 23 mm
Oil Charge: 150ml +/-15ml
Free Internal Volume: 1.5 cm³
Maximum Recommended Refrigerant Charge: 150 g
Oil Type Configuration: Alkylbenzene
Oil Type Viscosity: ISO5
Compressor pressurization: Light vacuum
Weight: 8 kg

ELECTRICAL DATA

Motor Type: RSCR
Starting Torque: LST
Voltage working range at 50 Hz: 198-254 V
Maximum Motor Temperature: 130 °C
Start Winding Resistance: 18.65 Ω (± 10%) at 25°C
Run Winding Resistance: 13.71 Ω (± 10%) at 25°C

MOUNTING ACCESSORIES

	Description	Code
Terminal Board:	no	-
Overload Protector Bracket:	no	-
Capacitor Bracket:	no	-
Washer:	no	-
Pin:	no	-
Clip:	no	-
Rotolock valve:	no	-
Grommets:	no	-
Sleeves:	no	-
Cover:	yes	2075282
Anchorage:	yes	1027058

ELECTRICAL COMPONENTS

	Component type	Description	Code
Starting Device:	TSD	TSD2 220V	513605512
Motor Protection:	External	4TM276KFBYY-73	2312012

EXTERNAL CHARACTERISTICS

Base Plate: European
Tray Holder: No
Height: 171 mm

	Internal Diameter (mm)	Material	Shape
Suction Connector	6.1	Copper	Slanted 42°
Discharge Connector	4.9	Copper	Straight
Process Connector	6.1	Copper	Slanted 46°

RATED POINT DATA

Cooling Capacity (W)	Power Consumption (W)	Current Consumption (A)	Gas Flow Rate (kg/h)	Efficiency (W/W)
±5%	±5%	±5%	±5%	±7%
158	116	0.57	2.06	1.36

Test condition: CECOMAF, Static, Return Gas 32°C, Subcooling OK, Evaporating: -25°C, Condensing: 55°C, Ambient: 32°C

PERFORMANCE CURVE DATA**220V 50Hz**

Condensing Temperature (°C)	Evaporating Temperature (°C)	Cooling Capacity (W)	Power Consumption (W)	Current Consumption (A)	Gas Flow Rate (kg/h)	Efficiency (W/W)
		±5%	±5%	±5%	±5%	±7%
35°C	-10	430	151	0.68	4.73	2.85
	-15	347	135	0.61	3.81	2.56
	-20	274	120	0.54	3.01	2.29
	-25	212	105	0.47	2.32	2.03
	-30	161	90	0.40	1.76	1.79
	-35	121	77	0.35	1.32	1.58

Condensing Temperature (°C)	Evaporating Temperature (°C)	Cooling Capacity (W)	Power Consumption (W)	Current Consumption (A)	Gas Flow Rate (kg/h)	Efficiency (W/W)
		±5%	±5%	±5%	±5%	±7%
45°C	-10	380	164	0.77	4.54	2.32
	-15	305	146	0.69	3.64	2.09
	-20	240	129	0.61	2.86	1.87
	-25	185	112	0.53	2.20	1.65
	-30	139	97	0.46	1.65	1.44
	-35	104	83	0.40	1.23	1.25

Condensing Temperature (°C)	Evaporating Temperature (°C)	Cooling Capacity (W)	Power Consumption (W)	Current Consumption (A)	Gas Flow Rate (kg/h)	Efficiency (W/W)
		±5%	±5%	±5%	±5%	±7%
55°C	-10	331	176	0.84	4.34	1.88
	-15	265	155	0.74	3.46	1.71
	-20	207	135	0.66	2.70	1.53
	-25	158	116	0.57	2.06	1.36
	-30	118	99	0.49	1.53	1.19
	-35	87	84	0.41	1.13	1.03

Test condition: CECOMAF, Static, Return Gas 32°C, Subcooling OK, Ambient: 32°C

ASSEMBLY INSTRUCTION

WIRING DIAGRAM

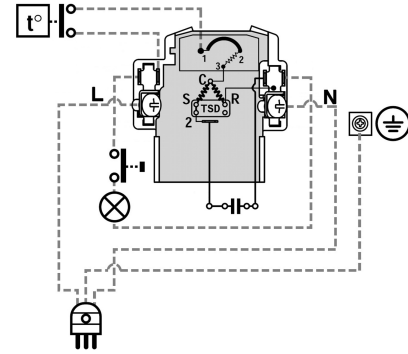
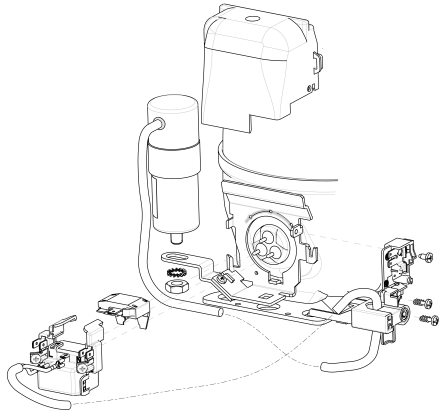

OPERATING ENVELOPE

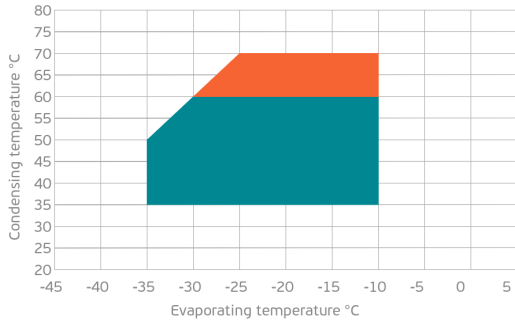

- Operating Condition
- Transient Condition
- Superheating

NOTE: usage of compressors outside of intended working range cannot make use of the warranty, or should be consulted with Technical support.

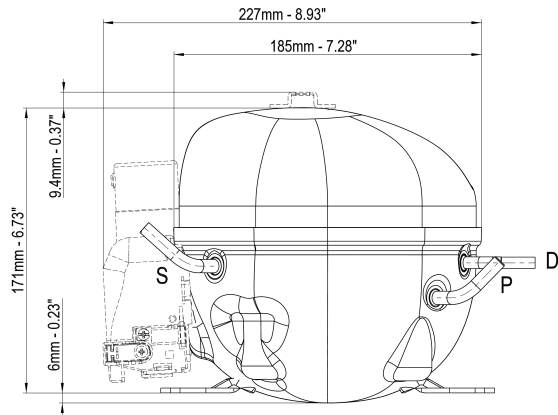

	∅ mm	∅ in	Material
S - Suction	6.10 - 6.20	0.24	Cu
P - Process	6.10 - 6.20	0.24	Cu
D - Discharge	4.90 - 5.02	0.19	Cu

