

**220-240V 50 1~****GENERAL DATA**

**Application:** LBP  
**Refrigerant:** R600a  
**Evaporating Temperature Range:** -35°C to -10°C  
**Compressor Cooling:** Static  
**Type:** Hermetic reciprocating  
**Technology Type:** On-Off  
**Expansion Device:** Capillary Tube  
**Packing Quantity:** Multi - 100 pcs  
**Displacement:** 11.14 cm<sup>3</sup>  
**Horse power:** 1.5 hp

Approvals:   

**MECHANICAL DATA**

**Bore:** 26 mm  
**Stroke:** 21 mm  
**Oil Charge:** 150ml +/-15ml  
**Free Internal Volume:** 1.5 cm<sup>3</sup>  
**Maximum Recommended Refrigerant Charge:** 150 g  
**Oil Type Configuration:** Alkylbenzene  
**Oil Type Viscosity:** ISO5  
**Compressor pressurization:** Light vacuum  
**Weight:** 7.4 kg

**ELECTRICAL DATA**

**Motor Type:** RSCR  
**Starting Torque:** LST  
**Voltage working range at 50 Hz:** 198-254 V  
**Maximum Motor Temperature:** 130 °C  
**Start Winding Resistance:** 22.47 Ω (± 10%) at 25°C  
**Run Winding Resistance:** 18.35 Ω (± 10%) at 25°C

**MOUNTING ACCESSORIES**

	Description	Code
<b>Terminal Board:</b>	no	-
<b>Anchorage:</b>	no	-
<b>Overload Protector Bracket:</b>	no	-
<b>Capacitor Bracket:</b>	no	-
<b>Washer:</b>	no	-
<b>Pin:</b>	no	-
<b>Clip:</b>	no	-
<b>Rotolock valve:</b>	no	-
<b>Cover:</b>	no	-
<b>Grommets:</b>	no	-
<b>Sleeves:</b>	no	-

**ELECTRICAL COMPONENTS**

Component type	Description	Code
----------------	-------------	------

**EXTERNAL CHARACTERISTICS**

**Base Plate:** European  
**Tray Holder:** Yes  
**Height:** 166 mm

	Internal Diameter (mm)	Material	Shape
<b>Suction Connector</b>	6.1	Copper	Slanted 42°
<b>Discharge Connector</b>	5.1	Copper	Slanted 48°
<b>Process Connector</b>	5.92	Copper	Slanted 43°

**RATED POINT DATA**

Cooling Capacity (W)	Power Consumption (W)	Current Consumption (A)	Gas Flow Rate (kg/h)	Efficiency (W/W)
±5%	±5%	±5%	±5%	±7%
192	110	0.55	2.06	1.75

Test condition: ASHRAE, Static, Return Gas 32.2°C, Evaporating: -23.3°C, Condensing: 54°C, Ambient: 32.2°C, Liquid: 32.2°C

**PERFORMANCE CURVE DATA**

**220V 50Hz**

Condensing Temperature (°C)	Evaporating Temperature (°C)	Cooling Capacity (W)	Power Consumption (W)	Current Consumption (A)	Gas Flow Rate (kg/h)	Efficiency (W/W)
		±5%	±5%	±5%	±5%	±7%
<b>35°C</b>	-10	393	133	0.65	4.23	2.95
	-15	317	118	0.59	3.40	2.68
	-20	252	103	0.53	2.70	2.45
	-25	197	89	0.48	2.11	2.21
	-30	152	78	0.43	1.63	1.94
	-35	117	72	0.38	1.25	1.62

Condensing Temperature (°C)	Evaporating Temperature (°C)	Cooling Capacity (W)	Power Consumption (W)	Current Consumption (A)	Gas Flow Rate (kg/h)	Efficiency (W/W)
		±5%	±5%	±5%	±5%	±7%
<b>45°C</b>	-10	379	148	0.72	4.08	2.56
	-15	303	131	0.64	3.26	2.32
	-20	239	113	0.57	2.56	2.11
	-25	185	97	0.50	1.98	1.89
	-30	140	85	0.44	1.50	1.66
	-35	106	77	0.39	1.13	1.38

Condensing Temperature (°C)	Evaporating Temperature (°C)	Cooling Capacity (W)	Power Consumption (W)	Current Consumption (A)	Gas Flow Rate (kg/h)	Efficiency (W/W)
		±5%	±5%	±5%	±5%	±7%
<b>55°C</b>	-10	365	163	0.78	3.93	2.24
	-15	291	143	0.69	3.13	2.04
	-20	227	123	0.61	2.44	1.85
	-25	174	104	0.53	1.86	1.67
	-30	131	89	0.46	1.40	1.46
	-35	97	79	0.40	1.03	1.22

Test condition: ASHRAE, Static, Return Gas 32.2°C, Ambient: 32.2°C, Liquid: 32.2°C

**ASSEMBLY INSTRUCTION**

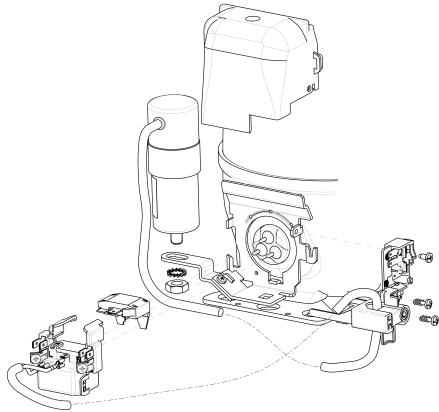

**WIRING DIAGRAM**

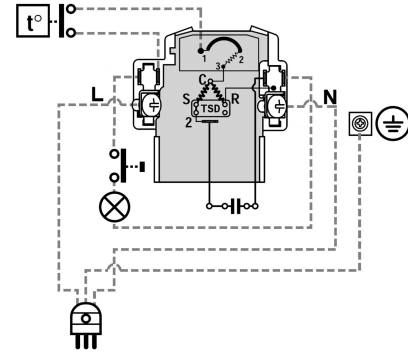

**OPERATING ENVELOPE**

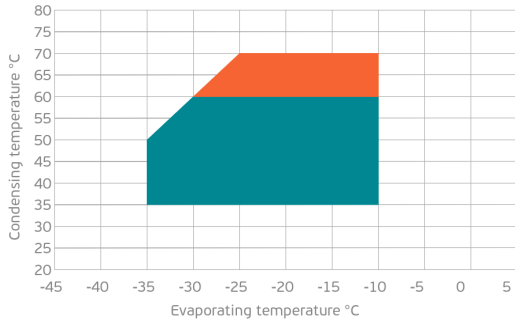

- Operating Condition
- Transient Condition
- Superheating

**NOTE:** usage of compressors outside of intended working range cannot make use of the warranty, or should be consulted with Technical support.

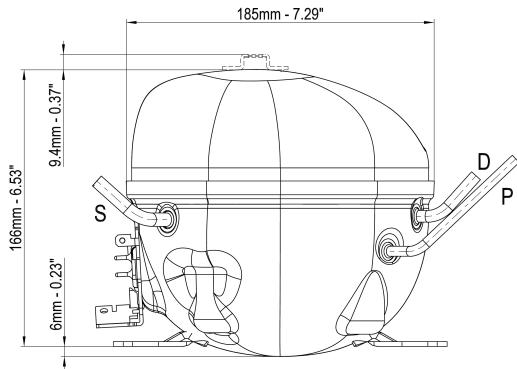

	∅ mm	∅ in	Material
<b>S - Suction</b>	6.10 - 6.20	0.24	Cu
<b>P - Process</b>	5.92 - 6.08	0.23	Cu
<b>D - Discharge</b>	5.10 - 5.20	0.20	Cu

